

Playpen Barrier

Fits openings 28.8" - 145.7" (73cm - 3.7m)

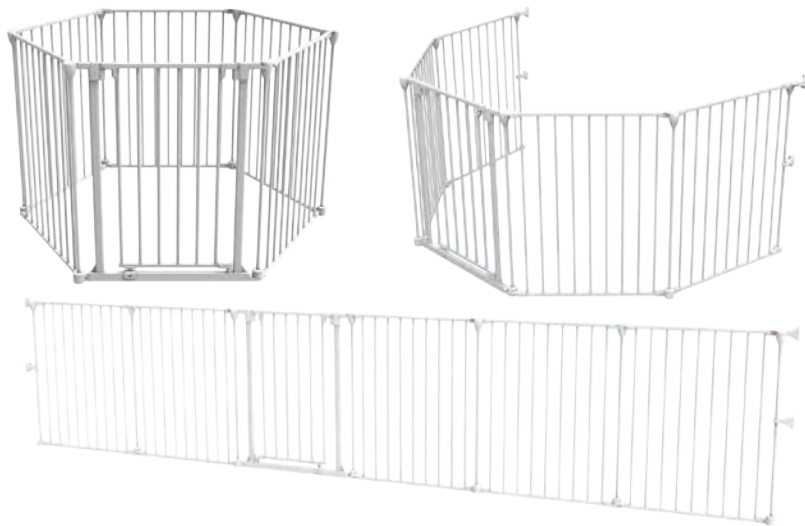

**IMPORTANT! READ AND FOLLOW
THESE INSTRUCTIONS CAREFULLY
AND KEEP FOR FUTURE REFERENCE.**

This product complies with safety standard ASTM F1004.

AFTER SALES SUPPORT

 info@childsafetyhelp.com

Product Code: 2747, 2751

For installation video, visit
www.permachildsafety.com/playpen-barrier-installation-video



Parts List

- A. 5x Barrier panel
- B. 1x Gate panel
- C. 1x Top underside wall bracket
- D. 1x Top topside wall bracket
- E. 2x Lower wall bracket
- F. 1x Top cap
- G. 1x Bottom cap
- H. 8x Screws
- I. 7x Corner tubes

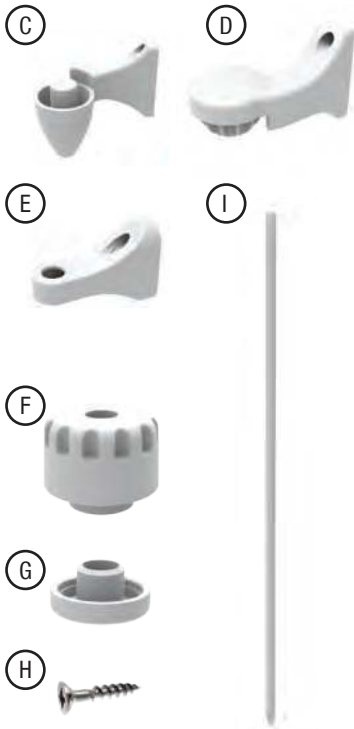

If any parts are missing do not attempt to use your Playpen Barrier.
Please call after sales support to obtain replacements.
Only use parts supplied by the manufacturer with your Playpen Barrier.

Safety Information

WARNING

- Adult Assembly Required
- To prevent serious injury or death, securely install gate or enclosure and use according to manufacturer's instructions.
- Never leave child unattended when using this product.
- Incorrect installation can be dangerous.
- Do not use the safety barrier if any components are damaged or missing.
- The safety barrier must not be fitted across windows.
- Never use with a child able to climb over or dislodge the gate or enclosure.
- Danger to older children if climbing over the product.
- Never install this product on glass doors. Install this product against reliable doors or walls.
- To prevent falls never use this product at the top of stairs.
- If the product is used at the bottom of stairs, in order to prevent a child climbing upstairs, it should be positioned on the lowest step.
- Do not put any goods which can be grabbed by children or pets near this product to prevent injury.

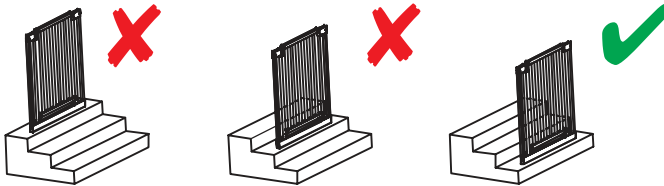

- Before using this product, carefully inspect for any loose parts and whether any parts need to be tightened.
- Make sure the product to be installed is horizontal and flat on the floor.
- This product is intended for use with children from 6 to 24 months or small to medium pets.
- Regularly check that the safety barrier is properly installed and secure.
- Any additional or replacement parts should be obtained from after sales support.
- Barrier must be fitted between rigid surfaces such as plaster board, timber or hardwall.
- Always check that the safety barrier is correctly closed.
- Children have died or been seriously injured when gates/enclosures are not securely installed. ALWAYS install and use gates/enclosures as directed using all required parts.
- Use only with the locking/latching mechanism securely engaged.
- NEVER use to keep child away from pool.

General Assembly

Select the appropriate fixing method from the following list. This barrier must only be fixed to a solid and secure surface. To install you will need a Phillips screwdriver, pencil and drill.

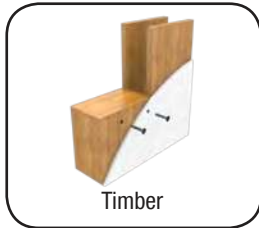

Timber



Plasterboard

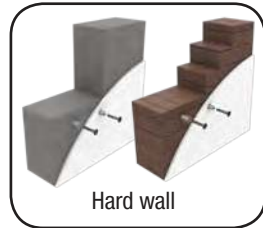

Hard wall

Timber Fixing

Drill 1/16" (2mm) pilot holes and use the timber screws provided screwing directly into the timber.

Plaster Board Walls

Locate timber stud and follow timber fixing instructions. Plaster board walls without studs require expandable wall plugs (not supplied), these are available at all DIY retailers.

Hard Wall Fixing (Concrete or Brick)

Hard wall surfaces require expandable wall plugs (not supplied), these are available at all DIY retailers.

If unsure, check with a qualified builder or tradesperson that the installation you intend is suitable and safe within the chosen location.

To Remove Unwanted Panels

Turn base knob to the unlocked position, pull up on the corner tube and slide the bottom of the corner tube out from the base. With the corner tube removed you can lift and remove the unwanted panel.

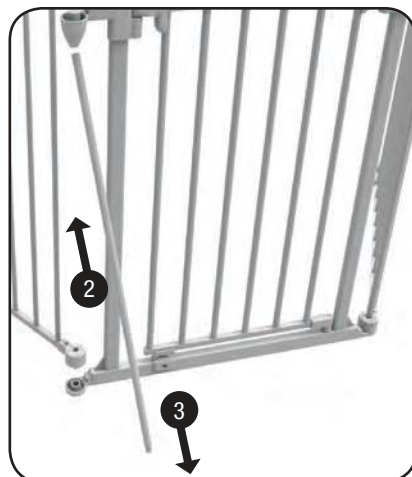
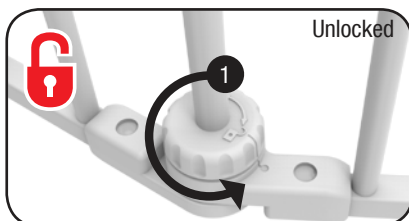
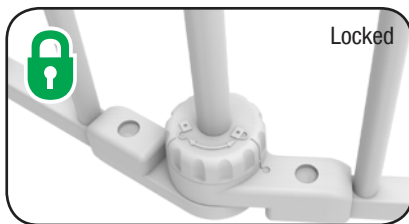



Adding Extra Panels

Align opposite ends of panels, place the corner tube into the top hole first, pull the corner tube up so you can position the bottom of the corner tube into the bottom hole.

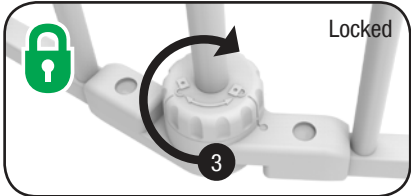
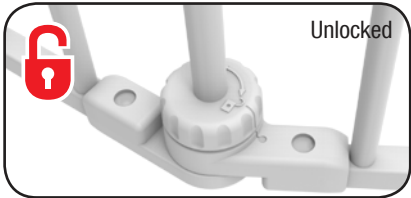

Turn the base knob into locked position to secure panels.

Underside Bracket Wall Assembly

Expanded:

Parts Required:

1x Top Underside Wall Bracket



(C)

1x Lower Wall Bracket



(E)

1x Bottom Cap



(G)

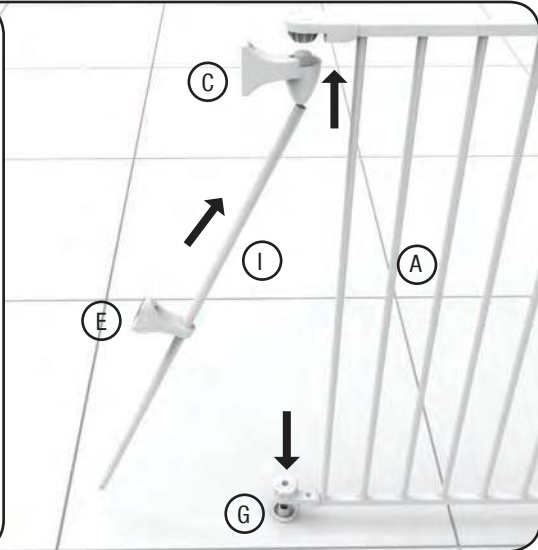

NOTE: Place Lower Wall Bracket (F) over Corner Tube (J) before assembly.

Assembled:





1. Mark screw positions with pencil.
2. Disassemble and screw in Top Underside Wall Bracket (C) and Lower Wall Bracket (E).



3. Reassemble Panel A, Corner Tube (I) and Bottom Cap (G) into Top Underside Wall Bracket (C) and Lower Wall Bracket (E).

Topside Bracket Wall Assembly

Expanded:

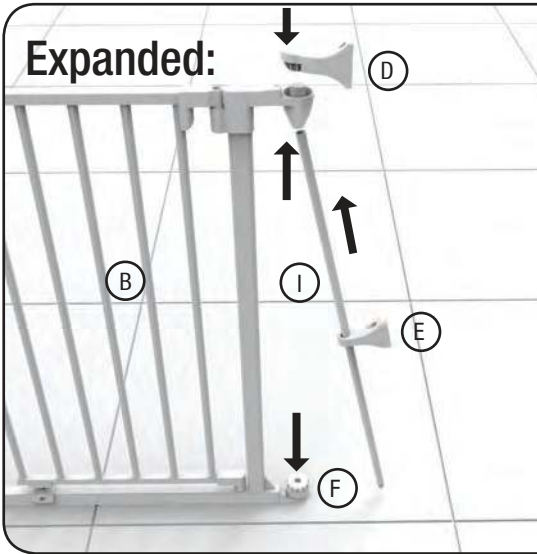

Parts Required:

- 1x Top Topside Wall Bracket
- 1x Lower Wall Bracket
- 1x Top Cap

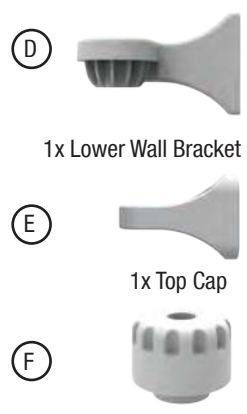

NOTE: Place Lower Wall Bracket (E) over Corner Tube (I) before assembly.





1. Mark screw positions with pencil.
2. Disassemble and screw in Top Topside Wall Bracket (D) and Lower Wall Bracket (E).

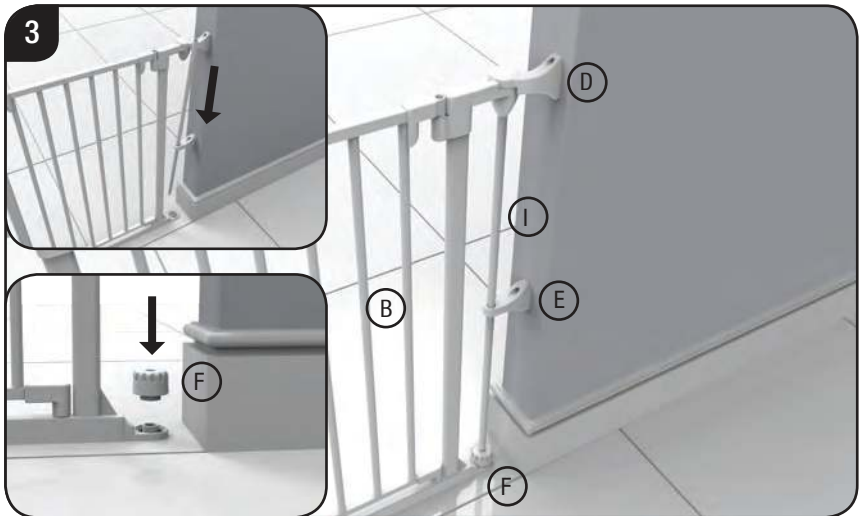

3. Reassemble Panel A, Corner Tube (I) and Top Cap (F) into Top Topside Wall Bracket (D) and Lower Wall Bracket (E).

Operation



Using one hand place thumb on the button and grip gate with fingers. Slide button and lift gate, then open gate in either direction, when released gate will swing closed automatically. Always check gate is properly closed. Up to 3 panels including the gate may be used in open configurations providing the 2 end panels are securely fixed to a wall with the fixings provided.

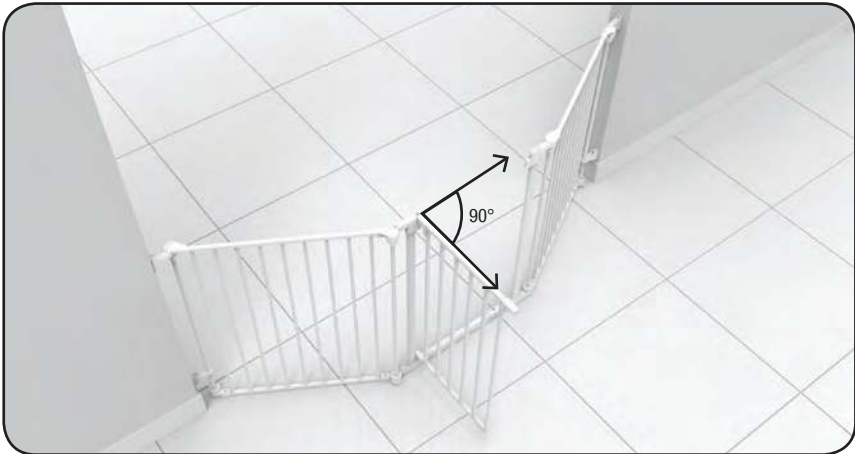

To enable stay open feature, completely open gate to a 90° angle.

Using Playpen Barrier as Room Divider or Safety Barrier

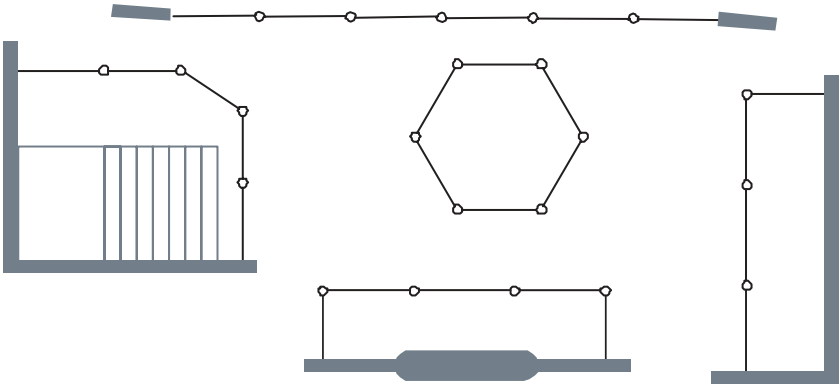

Up to 6 panels including the gate may be used in open configurations providing the 2 end panels are securely fixed to a wall with the fixings provided.

Playpen Assembly

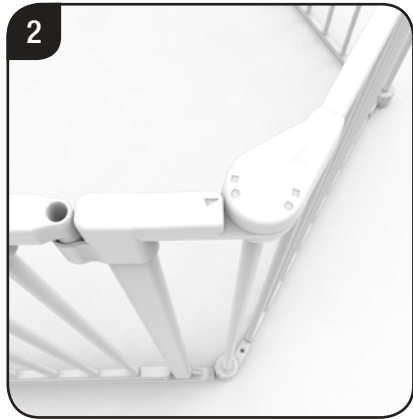

1. Align Panel A and Panel B/C, place the corner tube into the top hole first, pull the corner tube up so you can position the bottom of the corner tube into the bottom hole.
2. Align arrow with hexagon icon. Do this for all corners.

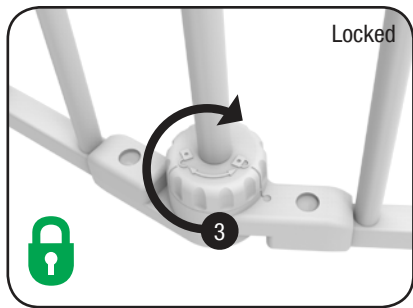

3. Turn the base knob into locked position to secure panels.

Safety Play Mat (Sold Separately)

Note: A safety play mat is required if playpen is used with children. The play mat is available separately, contact after sales support for details.
Your child's play mat can now be placed into the playpen and secured to the bottom bars of each panel with the ties.

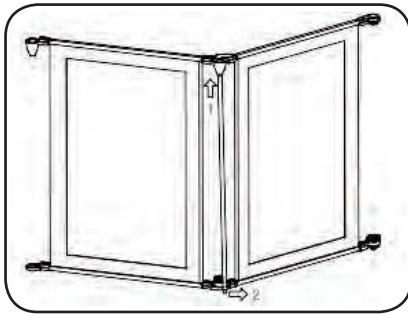

1. Release corner tube.

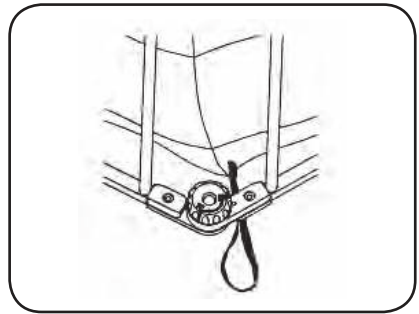

2. Place loop of play mat under the playpen.

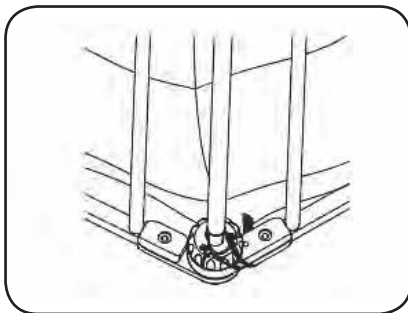

3. Install corner tube through loop and fix.

Warranty Certificate

Congratulations! You have made an excellent choice of this quality product. Our commitment to quality also includes our service. Should you, contrary to expectations, experience defects due to manufacturing faults, we will provide you with a warranty against defects as follows:

Warranty

The product is guaranteed to be free from defects in workmanship and parts for a period of 12 months from the date of purchase. Defects that occur within this warranty period, under normal use and care, will be repaired, replaced or refunded at our discretion.

You are entitled to a replacement or refund for a major failure and for compensation for any other reasonably foreseeable loss or damage. You are also entitled to have the goods repaired or replaced if the goods fail to be of acceptable quality and the failure does not amount to a major failure.

Proof of Purchase

This warranty is valid for the original purchase and is not transferable. Please keep your purchase docket, tax invoice or receipt as the best proof of purchase, and as proof of date on which the purchase was made.

Extent of Warranty

This warranty is limited to defects in workmanship or parts. All defective products or parts will be repaired or replaced. This warranty does not cover consumable items.

Normal Wear and Tear

This warranty does not cover normal wear and tear to the products or parts.

Exclusions

This warranty does not cover:

- Any defects caused by an accident, misuse, abuse, improper installation or operation, lack of reasonable care, unauthorized modification, loss of parts, tampering or attempted repair by a person not authorized by the distributor.
- Any product that has not been installed, operated or maintained in accordance with the manufacturer's operating instructions provided with the product.
- Any product that has been used for purposes other than domestic use.

To Make a Claim

If a defect in the goods appears within 12 months, you are entitled to claim a warranty. Please contact after sales support via the link below:

www.permachildsafety.com/contact

Please ensure that you have a copy of proof of purchase so that we are able to respond as quickly and efficiently as possible.



Playpen Barrier Warranty Card

Details:

Product Name: Playpen Barrier

Product Number: 2747, 2751

Your Name: _____

Address: _____

Phone: _____

Email: _____

Date of Purchase: _____

Location of Purchase: _____

We recommend that you keep a copy of your receipt, showing the date of purchase, with this warranty certificate and keep for your reference.

In the event of a product fault, please contact after sales support. Ensure that you include the product details (as shown on this card) so that we are able to respond as quickly and efficiently as possible.

AFTER SALES SUPPORT

 info@childsafetyhelp.com

Product Code: 2747, 2751

